

PROJECT NAME:
PHONE:

NICK MARTIN
Landscape Architect, Inc.
210 S. Juniper Ste. #106
Escondido, CA 92025
Phone (760) 735-8262 Fax (760) 735-8882
WebSite: www.nickmartinlandscape.com



DRAWN: NM
DATE: 4/16/07
SCALE: 1/10" = 1'-0"
JOB NAME: JARRETT
SHEET: L/2

NOTE: ALL INFORMATION, IDEAS & DETAILS INDICATED ON THIS SHEET IS THE PROPERTY OF NICK MARTIN LANDSCAPE ARCHITECT. ANY ATTEMPT TO REPRODUCE OR USE THIS INFORMATION WITHOUT THE EXPRESS PERMISSION OF NICK MARTIN IS PROHIBITED.

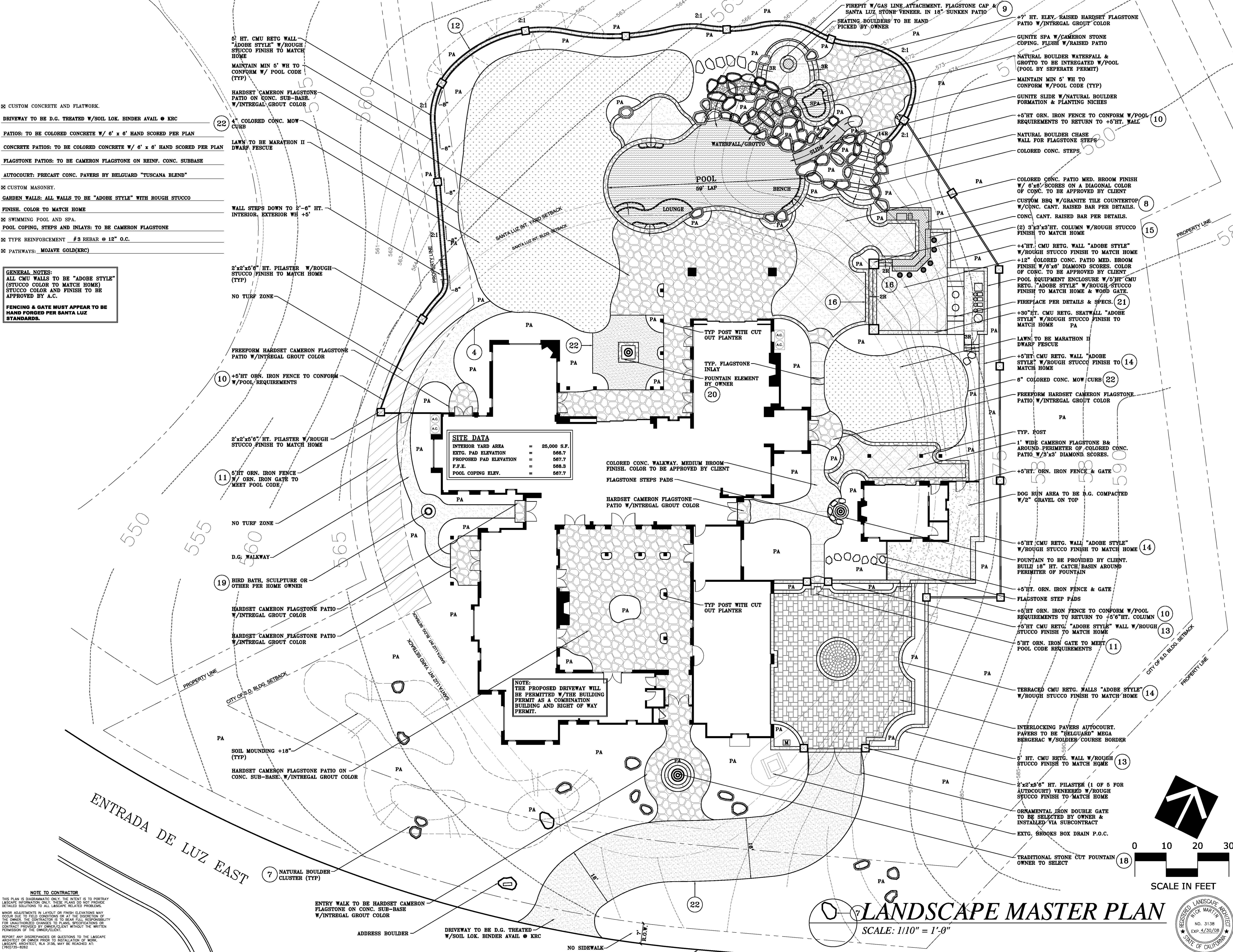

- ⊗ CUSTOM CONCRETE AND FLATWORK.
- DRIVEWAY TO BE D.G. TREATED W/SOIL LOK. BINDER AVAIL @ KRC
- PATIOS: TO BE COLORED CONCRETE W/ 6' x 6' HAND SCORED PER PLAN
- CONCRETE PATIOS: TO BE COLORED CONCRETE W/ 6' x 6' HAND SCORED PER PLAN
- FLAGSTONE PATIOS: TO BE CAMERON FLAGSTONE ON REINF. CONC. SUBBASE
- AUTOCOURT: PRECAST CONC. PAVERS BY BELGUARD "TUSCANA BLEND"
- ⊗ CUSTOM MASONRY.
- GARDEN WALLS: ALL WALLS TO BE "ADOBE STYLE" WITH ROUGH STUCCO FINISH. COLOR TO MATCH HOME
- ⊗ SWIMMING POOL AND SPA.
- POOL COPING, STEPS AND INLAIS: TO BE CAMERON FLAGSTONE
- ⊗ TYPE REINFORCEMENT #3 REBAR @ 12" O.C.
- ⊗ PATHWAYS: MOJAVE GOLD(KRC)

GENERAL NOTES:
ALL CMU WALLS TO BE "ADOBE STYLE" (STUCCO COLOR TO MATCH HOME)
STUCCO COLOR AND FINISH TO BE APPROVED BY A.C.
FENCING & GATE MUST APPEAR TO BE HAND FORGED PER SANTA LUZ STANDARDS.

NOTE TO CONTRACTOR
THIS PLAN IS DIAGRAMMATIC ONLY. THE INTENT IS TO PORTRAY LANDSCAPE INFORMATION ONLY. THESE PLANS DO NOT PROVIDE DETAILED SOLUTIONS TO ALL LANDSCAPE RELATED PROBLEMS.
MINOR ADJUSTMENTS IN LAYOUT OR FINISH ELEVATIONS MAY OCCUR DUE TO FIELD CONDITIONS OR AT THE DISCRETION OF THE OWNER. THE CONTRACTOR IS TO BEAR FULL RESPONSIBILITY FOR UNAUTHORIZED CHANGES TO PLANS, SPECIFICATIONS OR CONTRACT PROVIDED BY OWNER/CLIENT WITHOUT THE WRITTEN PERMISSION OF THE OWNER/CLIENT.
REPORT ANY DISCREPANCIES OR QUESTIONS TO THE LANDSCAPE ARCHITECT OR OWNER PRIOR TO INSTALLATION OF WORK.
LANDSCAPE ARCHITECT, RLA 3138, MAY BE REACHED AT: (760) 735-8262

LANDSCAPE MASTER PLAN
SCALE: 1/10" = 1'-0"

